

# Connecting to Rovernet 2.0 with the iPod Touch

Rovernet 2.0 is a Michigan Tech WPA Enterprise Solution that allows for greater flexibility and security when accessing the campus wireless network. The “**MichiganTech-Mobile**” (SSID) is only accessible via WPA Enterprise (PEAP) authentication. Once authenticated, the traffic is encrypted. To obtain access to this encrypted network, wireless clients will be required to configure their devices for WPA/WPA2 authentication.

## Minimum System Requirements

- Be within the “**MichiganTech-Mobile**” SSID wireless coverage areas.
- Be a current Michigan Tech student, faculty, or staff member.
- Have a valid ISO User Name and Password.
- Have an 802.11 b/g compatible mobile device capable of WPA security.
- **Important!** Have the iPhone/iPod 2.2.1 (or higher) software update applied.

## Adding and Configuring the “MichiganTech-Mobile” SSID

1. Navigate to **Settings**.



2. Select **Wi-Fi** to move to the Wi-Fi Screen.
  - a. Make sure that your Wi-Fi connection is turned on.

**Note: If the “MTU” SSID is checked, you need to forget this network before you can successfully connect to the Rovernet 2.0 network.**

- b. To forget the **MTU** network:
  - i. Click on the **blue arrow** to the right of the MTU name.



- ii. Click on **“Forget This Network”**



- iii. Click **Forget Network**, when prompted.
  - iv. Click on the **“Wi-Fi Networks”** button to go back to the network listing.

3. To connect to the 'MichiganTech-Mobile' Network:
  - a. Select "**MichiganTech-Mobile**" from the **Choose a Network** List. (If the "**MichiganTech-Mobile**" SSID is not in your list, you are not within range of a "**MichiganTech-Mobile**" secured wireless access point).



- b. When prompted, fill in the information as shown below:
  - i. Enter your **ISO User name** in the **Username** field.
  - ii. Enter your **ISO Password** in the **Password** field.
  - iii. Press the **Join** button located in the bottom right corner of the display.

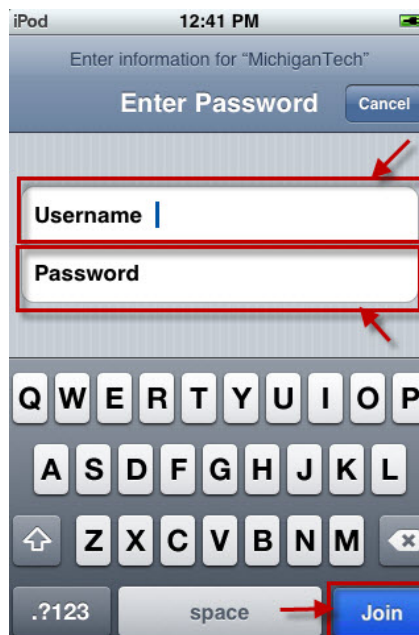

- c. Verify the **www.login.mtu.edu** Certificate for the “MichiganTech-Mobile” network by clicking **Accept** as shown below.

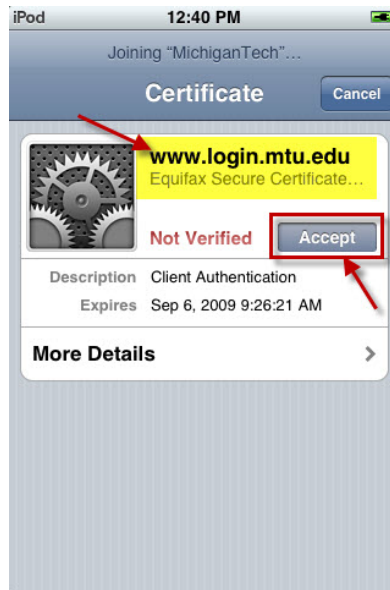

Once the certificate has been accepted, you should be redirected back to the Wi-Fi Networks screen. If you have successfully connected, you will notice a **Check Mark** next to the “MichiganTech-Mobile” network.

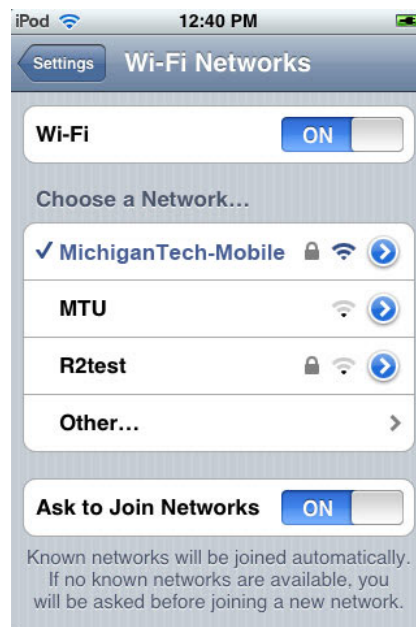

If you are unable to connect, please check to make sure you entered your ISO User name and Password correctly in step b. Refer to the Initial Sign-On (ISO) Site at [www.login.mtu.edu](http://www.login.mtu.edu)), If you have forgotten your MTU ISO password.